

Printed 5/8/2009

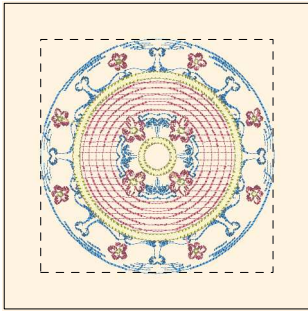

- 1. Peacock Blue (Sul-R:1134)
- 2. Coral (Sul-R:1154)
- 3. Pale Yellow (Sul-R:1061)
- 4. Lemon Yellow (Sul-R:1067)

Vintage_plates_01-6x10.dst
5.98x6.00 inches; 18,517 stitches
4 thread changes; 4 colors

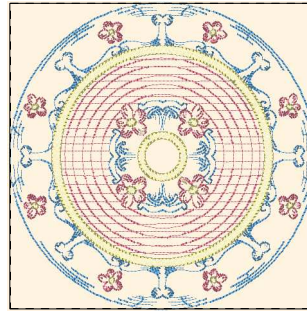

- 1. Peacock Blue (Sul-R:1134)
- 2. Coral (Sul-R:1154)
- 3. Pale Yellow (Sul-R:1061)
- 4. Lemon Yellow (Sul-R:1067)

Vintage_plates_01-8x8.dst
7.83x7.86 inches; 23,643 stitches
4 thread changes; 4 colors

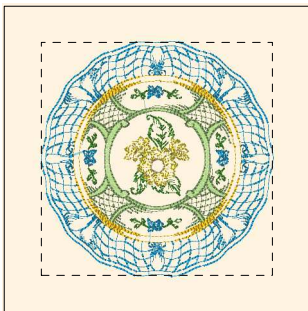

- 1. Chartreuse (Sul-R:1322)
- 2. Goldenrod (Sul-R:1024)
- 3. Grass Green (Sul-R:1049)
- 4. Sun Yellow (Sul-R:1124)
- 5. Pistachio (Sul-R:1276)
- 6. Dk. Ecru (Sul-R:1128)
- 7. Duck Wing Blue (Sul-R:1250)

Vintage_plates_02-6x10.dst
5.95x6.00 inches; 18,631 stitches
7 thread changes; 7 colors

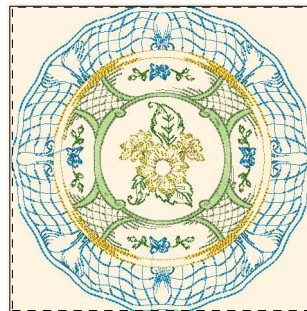

- 1. Chartreuse (Sul-R:1322)
- 2. Goldenrod (Sul-R:1024)
- 3. Grass Green (Sul-R:1049)
- 4. Sun Yellow (Sul-R:1124)
- 5. Pistachio (Sul-R:1276)
- 6. Dk. Ecru (Sul-R:1128)
- 7. Duck Wing Blue (Sul-R:1250)

Vintage_plates_02-8x8.dst
7.73x7.81 inches; 22,944 stitches
7 thread changes; 7 colors

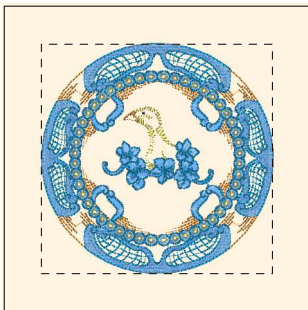

- 1. Butterfly Gold (Sul-R:567)
- 2. Med. Blue (Sul-R:1029)
- 3. Lemon Yellow (Sul-R:1067)
- 4. Duck Wing Blue (Sul-R:1250)
- 5. Blue Black (Sul-R:1182)

Vintage_plates_03-6x10.dst
5.95x5.91 inches; 33,745 stitches
5 thread changes; 5 colors

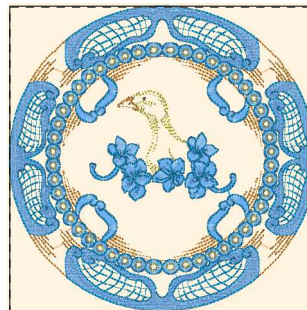

- 1. Butterfly Gold (Sul-R:567)
- 2. Med. Blue (Sul-R:1029)
- 3. Lemon Yellow (Sul-R:1067)
- 4. Duck Wing Blue (Sul-R:1250)
- 5. Blue Black (Sul-R:1182)

Vintage_plates_03-8x8#.dst
7.87x7.82 inches; 45,199 stitches
5 thread changes; 5 colors

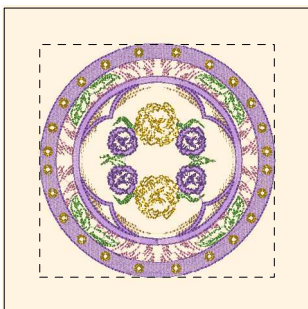

- 1. Hyacinth (Sul-R:1296)
- 2. Goldenrod (Sul-R:1024)
- 3. Nile Green (Sul-R:1274)
- 4. (Sul-R:622)
- 5. Med. Purple (Sul-R:1032)
- 6. Lt. Coral (Sul-R:1148)

Vintage_plates_04-6x10.dst
6.04x5.99 inches; 28,531 stitches
6 thread changes; 6 colors

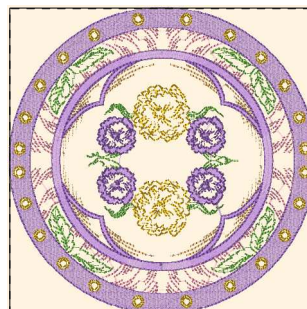

- 1. Hyacinth (Sul-R:1296)
- 2. Goldenrod (Sul-R:1024)
- 3. Nile Green (Sul-R:1274)
- 4. (Sul-R:622)
- 5. Med. Purple (Sul-R:1032)
- 6. Lt. Coral (Sul-R:1148)

Vintage_plates_04-8x8#.dst
7.87x7.84 inches; 38,521 stitches
6 thread changes; 6 colors

Printed 5/8/2009

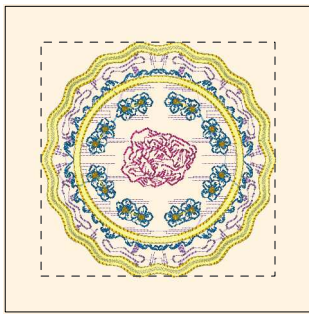

- 1. Hyacinth (Sul-R:1296)
- 2. Deep Rose (Sul-R:1511)
- 3. Lemon Yellow (Sul-R:1067)
- 4. (Sul-R:1290)
- 5. Goldenrod (Sul-R:1024)

Vintage_plates_05-6x10.dst
6.02x6.02 inches; 24,001 stitches
5 thread changes; 5 colors